

“COST ANALYSIS”

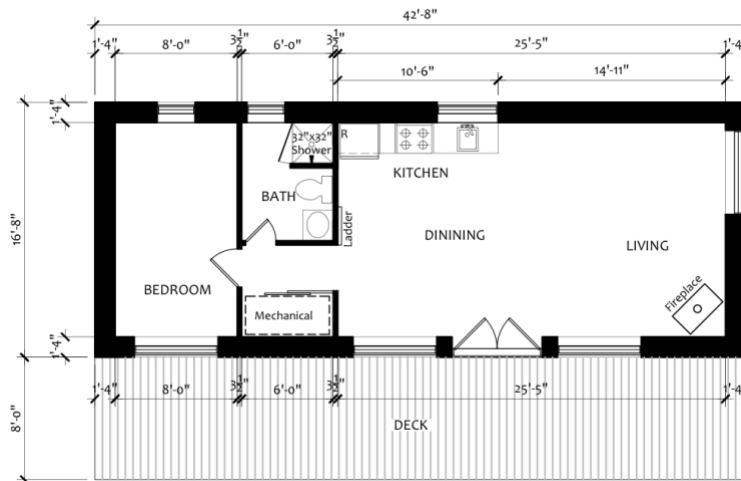

Model: Swede

Style: EkoCoachHouse

Location:

'HOUSE' SPECIFIC COSTS

Design

- Main floor – 16'8" x 39' - 650 ft.²
 - Loft floor – 265 ft.²
 - Ceilings 9' walls c/w cathedral ceiling 10/12 pitch
 - Overhangs – 18" @ eaves, 2' @ gables
-

Foundation \$32,500

- granular base
 - slab-on-grade style foundation, steel trowel finish
 - styrofoam tray beneath slab
-

Weathertight Materials Package

- Weather-tight shell materials
 - Passive - \$108,207
 - Includes \$22,500 window/door budget
-

Weathertight Materials Installation

- Weather-tight shell Installation
 - Passive - \$41,175
-

Roof Cover \$19,866

- Steel Roofing, Ideal Wakefield Bridge



Fascia / Soffit \$5,735

- Aluminum fascia & soffit

Exterior Siding & Trim \$28,111

- Exterior siding, LP Adams engineered wood maintenance-free siding -
- Exterior Window / Door Trim, LP Adams

Insulation \$19,005

- Exterior Walls - dense-pack Cellulose, R75
- Roof – dense-pack Cellulose, R110

Plumbing 10k

- ABS, Pex pipe & fittings to all fixtures
- 2 exterior hose taps

Electrical 15k

- 200 amp service
- All wiring to plugs, switches & mechanicals
- 2 exterior plugs

HVAC 17.5k

- Heating– Heat Pump
- HRV& Air Conditioning – Blauberg



Drywall 12.5k

- Drywall for all walls & ceilings, ready for paint

TOTAL (house to drywall stage)

Passive - \$309,599 + hst

INTERIOR FINISHINGS, example— 40k

- Paint for walls & ceilings (5k)
- Cleaned & sealed concrete floor (5k)
- Kitchen & Vanities c/w laminate counters (12k)
- Carpentry - interior doors, window / door trim, baseboards (12k)
- Plumbing / electrical fixtures (3.5k)
- Tiles @ washrooms (2.5k budget)

NOTES:

- Building Permits are not included
- Site work is not included (excavation, backfill, services, laneway, landscaping, etc...)
- Project Management is not Included

